

GC Supplies

Agilent Instrument Parts and Supplies

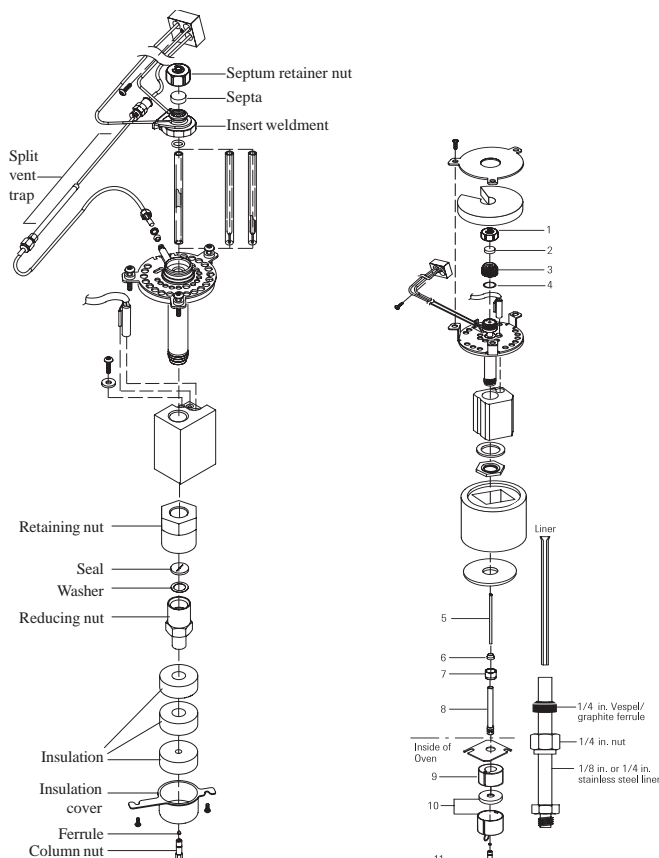

6890/6850 GC
Split/Splitless Inlet

6890/6850 GC
Packed Port Inlet

6890/6850 Split/Splitless Inlet Supplies

Cat. No.	Description
18740-60830	Septum retainer nut for headspace
18740-60835	Septum retainer nut
5183-4757	Septa, bleed temperature optimized, 50/pk
19251-60575	Insert weldment standard manual pneumatics
G1544-60575	Orig. std EPC using 1/4" split vent filter
G1544-60585	S/SL insert weldment
5180-4168	Graphite o-rings for split liner, 12/pk
5180-4173	Graphite o-rings for split liner, 10/pk
5180-4182	Fluorocarbon elastomer o-ring, 10/pk
5183-4647	Liner, split, glass wool, taper, deact., 25/pk
5181-3316	Liner, splitless, taper, deact., each
5183-4696	Liner, splitless, taper, deact., 25/pk
G1544-60610	Split trap vent kit w/repl. cart., optional
G1544-80530	Replacement cartridge for G1544-60610
G1544-80550	Slit vent trap assembly
G1544-20590	Retaining nut
18740-20880	SS seal
18740-20885	Gold plated seal
5182-9652	Gold plated seal with cross
5061-5869	Washer, 0.375" OD
18740-20800	Reducing nut
19243-00067	Insulation (requires 3)

6890/6850 Packed Port Inlet Supplies

Selecting Adapters and Liners for Packed Inlets

For purged-packed inlets, adapter selection is dependent on the type of column used: 1/4" packed, 1/8" packed, or 0.53mm. It allows the columns to be connected to the inlet. Glass liners are often used with metal adapters to reduce reactivity and trap nonvolatile residues. Liners are installed from the top of the inlet and should be installed before the column.

Cat. No.	Description	Qty.
18740-60835	¹ Septum nut	1
5183-4757	² Septa, BTO, 11mm	50
19243-80570	³ Top insert weldment	1
5080-8898	⁴ Viton o-rings	12
5080-8732	⁵ Glass liner, disposable	25
5181-3382	⁵ Glass liner, disposable/deactivated	5
5080-8774	⁶ Vespel/graphite ferrules, 1/4" ID	10
5180-4105	⁷ Tubing nut, 1/4" brass	10
19244-80540	⁸ 0.53mm column adapter w/glass liner	1
19243-80530	⁸ 1/8" column adapter w/glass liner	1
19243-00067	⁹ Upper insulation	1
19234-60720	¹⁰ Nut warmer cup with insulation	1
5181-8830	¹¹ Column nut for 0.53mm column	2

7694 Headspace Sampler Supplies

Cat. No.	Description
301-222-HSP	Needle, transfer line, Silcosteel
301-220-HSP	Needle assembly vial probe, Silcosteel
301-015-HSP	Needle for transfer line, 0.4 ID, 0.8mm OD, Ni
301-016-HSP	Needle for transfer line, 0.25 ID, 0.5 OD, Ni
301-212-HSP	Tube, needle, 6-port valve, Silcosteel
301-013-HSP	Needle assembly (vial probe)

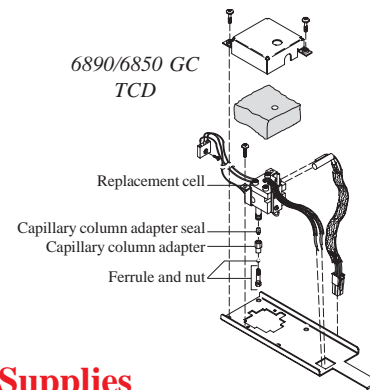

6890/6850 TCD Supplies

Cat. No.	Description
G1532-60675	TCD replacement cell
18740-20950	TCD cap column adapter seal
18740-20960	TCD cap column adapter

6890 ECD Supplies

Cat. No.	Description
19234-60720	Nut warmer cup with insulation
18713-60040	ECD chemical sample kit, 3 ampoules